

Instruction for UNIPAK jointing compound & FLAX

перейти на сайт: www.san-detal.ru

Get the right starts undoing the Flax:

Loosen the end of the flax, which is winded around the ball of Flax.

Wind it on to the now open ball of flax.

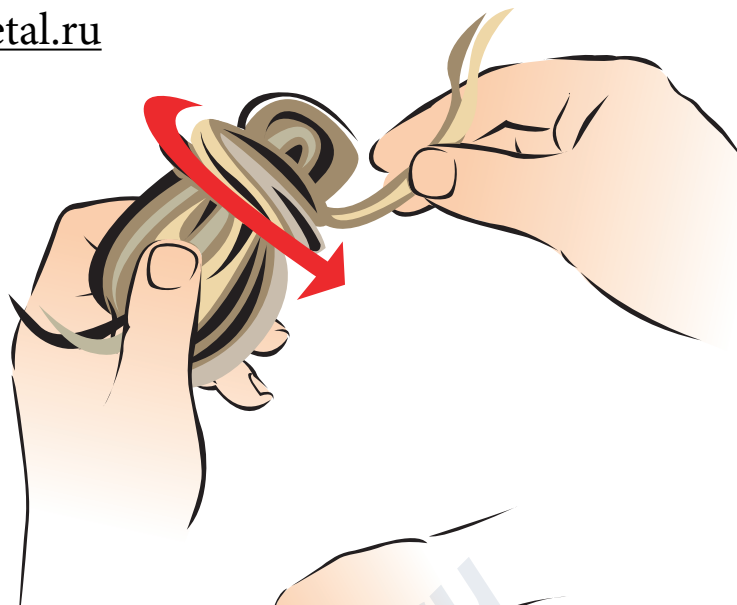

Instruktion for use:

Start from the middle of the ball of flax. Pull a *suitable amount of flax out and hold it as shown in the drawing, pull it apart with caution.

(*Depends on the dimension of the pipe, by 1/2" approx 20cm.)



The flax is now winded even and tightly onto the thread, from the pipe-end and in. (Rising with the thread.)

The thread should be filled with flax, leaving the top of the thread visible. Do not allow flax to cross the pipe opening.

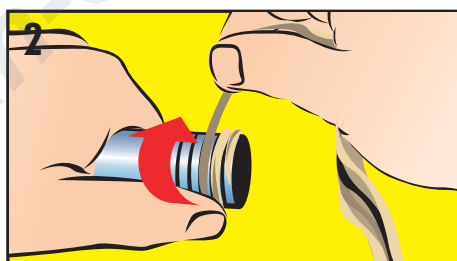

Cover the flax with an even layer off UNIPAK jointing compound, make sure all the flax is covered with an even layer. The jointing compound is applied using the fingers rising with the thread.

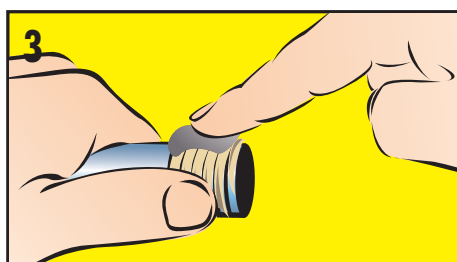

Tube and fittings can be assembled and taken into use at ones. UNIPAK jointing compound and UNIPAK flax allows readjustment of fittings and tubes. Surplus jointing compound on tubes should be removed with a cloth or a steel-brush.

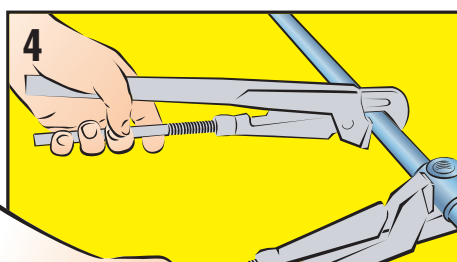

Unipak